

THE BELLECOUR ROOM

LUNCH OR DINNER FOR 30 PERSONS (MAXIMUM)
WITH COCKTAIL RECEPTION IN THE BELLECOUR ROOM

Service Entrance

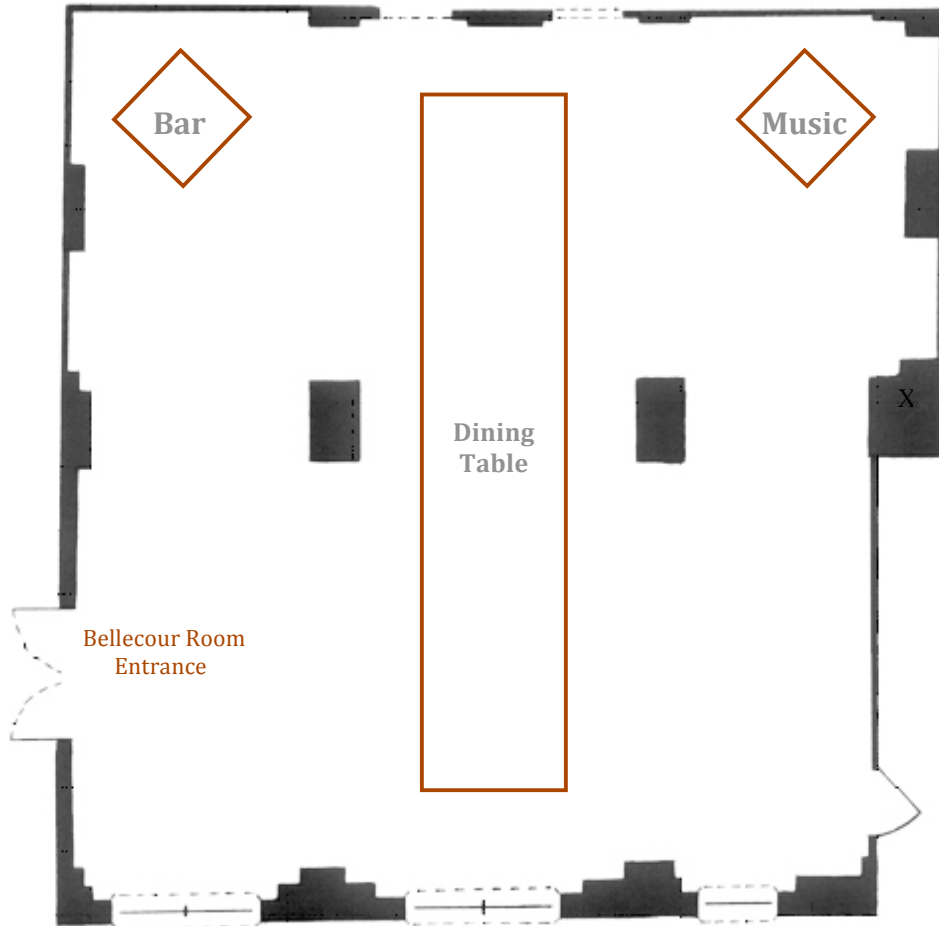

Guest Entrance from
the Upper Lounge of
Restaurant DANIEL

Bellecour Room
Entrance

Scale: 1/6 inch = 1 foot

East 65th Street